

Blackpool Council

The Animal Welfare (Licensing of Activities Involving Animals) (England) Regulations 2018

Application for a licence to Breed Dogs

Please complete all the questions in the form.

If you have nothing to record, please state "Not applicable" or "None"

1a	Agent			
1.1	Are you an agent acting on behalf of the applicant	Yes	No	✓ If no, go to 2.1
1b	Further information about the Agent			
1.2	Name	N/A		
1.3	Address	N/A		
1.4	Email	N/A		
1.5	Main telephone number	N/A		
1.6	Other telephone number	N/A		
2	Applicant details			
2.1	Name	KATHRYN STOCK		
2.2	Address			
2.3	Email			
2.4	Main telephone number			
2.5	Other telephone number	N/A		
2.6	Are you applying as a business or organisation, including a sole trader	Yes	No	
2.7	Are you applying as an individual	Yes	No	
3a	Applicant Business			
3.1	Is your company registered with companies house	Yes	No	If no, go to 3.3
3.2	Registration Number	N/A		
3.3	Is your business registered outside the UK	NO		
3.4	VAT Number	NA		
3.5	Legal status of the business	SOLE TRADE		
3.6	Your position in the business	SELF EMPLOYED		
3.7	The country where your head office is located.	AS ABOVE		
3b	Business Address – This should be your official address – The address required of you by law to receive all communication			
3.8	Building name or number			
3.9	Street			
3.10	District			
3.11	City or Town			
3.12	County or administrative area			
3.13	Post Code			
3.14	Country			

4a	Type of Application		
4.1	Type of Application	New	Renewal
4.2	Existing licence number		
4b	Animals to be accommodated		
4.3	Wholly indoors	Wholly outdoors	✓
4.4	Breeds of dogs concerned		
4.5	Number of bitches kept		
4.6	Owned by the applicant ✓	Co owned by the applicant	On breeding terms
4.7	Provide details of the ages of bitches kept.		
4.8	Number of studs kept 1		
4.9	Owned by the applicant	Co owned by the applicant ✓	On breeding terms
4.10	Provide details of the ages of the studs kept 10 months		
4c	Further information about the applicant		
4.11	Date of birth		
5	Premises to be licensed		
5.1	Name of premises/trading name N/A		
5.2	Address of premises		
5.3	Telephone number of premises		
5.4	Email address		
5.5	Do you have planning permission for this business use. Planning consalte and deemed not re uired Yes/No		
6	Accommodation and facilities		
6.1	Details of the quarters used to accommodate animals, including number, size and type of construction Full details on sublimantar Pa e		
6.2	Exercise facilities and arrangements Trans orbed to an ci d rivate id		
6.3	Heating arrangements: e lam /central heating		
6.4	Method of ventilation of premises Natural Fans ins id il		
6.5	Lighting arrangements (natural & artificial) tben m s		
6.6	Water supply wt r'tural l med & illed		
6.7	Facilities for food storage & preparation dr kibbel s re indoors		
6.8	Arrangements for disposal of excreta, bedding and other waste material ed and dis osed in wheelie bin		
6.9	Isolation facilities for the control of infectious diseases Isolation area to be constructed in Gara		
6.10	Fire precautions/equipment and arrangements in the case of fire Fire extin uisher & ire lan L. woo 1 - fire&rescu train d		
6.11	Do you keep and maintain a register of animals? Yes/No		
6.12	How do you propose to minimise disturbance from noise? reduce numbers, star ins with noise . humane anti bark devices 1 mo . humane anti bark collars bought and in use Sound engineers Consulted & 2 options explored		

7	Veterinary surgeon		
7.1	Name of usual veterinary surgeon		
7.2	Company name		
7.3	Address		
7.4	Telephone number		
7.5	Email address		
8a	Emergency key holder		
8.1	Do you have an emergency key holder?	e No	If no, go to 9.1
8.2	Name		
8.3	Position/job title		
8.4	Address		
8.5	Daytime telephone number		
8.6	Evening/other telephone number		
8.7	Email address	N/A	
8.8	Add another person?	Yes/No	If no, go to 9.1
8b	Emergency key holder 2		
8.9	Do you have an emergency key holder?	Yes/No	If no, go to 9.1
8.10	Name		
8.11	Position/job title		
8.12	Address		
8.13	Daytime telephone number		
8.14	Evening/other telephone number	N/A	
8.15	Email address	N/A	
9	Public liability insurance		
9.1	Do you have public liability insurance?	Yes/No	If no, go to 9.6
9.2	Please provide details of the policy	N/A	
9.3	Insurance company	N/A	
9.5	Policy number	N/A	
9.6	Period of cover	N/A	
9.7	Amount of cover (£)	N/A	
9.8	Please state what steps you are taking to obtain such insurance		
10	Disqualifications and convictions		
	Has the applicant, or any person who will have control or management of the establishment, ever been disqualified from:		
10.1	Keeping a pet shop?	Yes	
10.2	Keeping a dog?	Yes/No	
10.3	Keeping an animal boarding establishment?	Yes/ o	
10.4	Keeping a riding establishment?	Yes/ o	
10.5	Having custody of animals?	Yes	
10.6	Has the applicant, or any person who will have control or management of the establishment, been convicted of any offences under the Animal Welfare Act 2006?	Yes/No	

10	Disqualifications and convictions	
10.7	Has the applicant, or any person who will have control or management of the establishment, ever had a licence refused, revoked or cancelled?	Yes <input checked="" type="radio"/> No <input type="radio"/>
10.8	If yes to any of these questions, please provide details,	N/A

11	Additional details	
Please check local guidance notes and conditions for any additional information which may be required		
11.1	Additional information which is required or may be relevant to the application	N/A

12	Model Licence Conditions & Guidance	
All applicants to tick that they have read the applicable model licence conditions & guidance		
12.1	The Breeding and Sale of Dogs	<input checked="" type="checkbox"/>

13	Additional Information	
Please attach the following Information		
13.1	A plan of the premises	
13.2	Operating procedures	
13.3	Risk Assessments (including Fire)	
13.4	Infection control procedure	
13.5	Training records	

14	Declaration	
14.1	This section must be completed by the applicant. If you are an agent please ensure this section is completed by the applicant.	
14.2	I am aware of the provisions of the relevant Act and model licence conditions. The details contained in the application form and any attached documentation are correct to the best of my knowledge and belief.	
14.3	Signing this box indicates you have read and understood the above declaration	KS
14.4	Full Name	KATHRYN STOCK
14.5	Capacity	
14.6	Date	14/12/18

Please Return to:
Licensing Service
Blackpool Council
Municipal Building
Corporation Street
Blackpool
FY1 1NA

Email: licensing@blackpool.gov.uk

4.5

<u>Name</u>	<u>Breed</u>	<u>Sex</u>	<u>Age</u>
Willow	Labrador	Female	2
Jess	Cocker Spaniel	Female	5
Katie	Cavalier King Charles	Female	4
Molly	Cavalier King Charles	Female	11 Months
Hattie	Cavalier King Charles	Female	7 Months
Sarsar	Pomeranian	Female	10 Months
Felicia	Pomeranian	Female	10 Months
Coco	Pomeranian	Female	7 Months
Tim	Pomeranian	Male	10 Months

6.1

Indoor space:

Laminated flooring with puppies/dogs contained within galvanised puppy panels. Heated via central heating and heat lamps.

Outdoor space:

Fully contained concrete area to rear.

Concrete area to side set at a gradient with a channel drain. Set onto this will be 3 off kennels, constructed of polyethylene panels with galvanised trim.

External runs provided with galvanised panels and gates.

Internally these will be lit with batten lamps and heated via thermostatically controlled heat lamps.

Kathryn Stock
8 St Martins Road
Blackpool
Lancashire
FY4 2DY

Dog breeding operating procedure

Contents

Puppies life plan	P 3
Adult dogs	P 7
Infection control	P 7
Veterinary contacts	P 7
Out of hours veterinary contacts	P 8
Cleaning and hygiene	P 8
Food	P 8
Emergency contacts	P 8
Visitors	P 9
Fire	P 9
Daily routine	P 10

Puppies life plan

Until all puppies are fully vaccinated the following must be in place:

Disinfectant mat located at the front door.

Foot dips to be used and located at entrances to any room containing puppies.

Sanitising hand gels located in close proximity to puppies, and to be used before and after handling.

Birth

At birth all puppies are to be cleaned, warmed, weighed, ID collared, plasma administered, and to suckle from mother for colostrum.

Should mother not produce enough milk at the start, puppies are to be supplemented with Royal Canin ProTech puppy milk and colostrum replacement.

Week 1

Puppies placed onto mother to feed every 3 hours as a minimum.

Puppies given plasma every 12 hours for the first 36 hours of life.

Suitable movement and activity to be monitored. Any puppies not demonstrating suitable movement to be closer monitored. Should their condition deteriorate they are to be presented to the vet.

Weighed daily to monitor growth.

Week 2

Puppies placed onto mother to feed every 4 hours as a minimum.

Suitable movement and activity to be monitored. Any puppies not demonstrating suitable movement to be closer monitored. Should their condition deteriorate they are to be presented to the vet.

Weighed daily to monitor growth.

Puppies are to be inspected daily for eyes opening and any abnormalities that may present themselves.

Wormed with Panacur 3 day wormer.

Flea treated with FiprocLEAR spray.

Week 3

Puppies allowed to nurse from mother when they are hungry.

Supplemented with Skinners puppy milk twice daily.

Suitable movement and activity to be monitored. Any puppies not demonstrating suitable movement to be closer monitored. Should their condition deteriorate they are to be presented to the vet.

Weighed daily to monitor growth.

Additional human interaction given, play time with both adults and children.

Noises introduced slowly, hair dryer, radio on, progressing to hoovering in the same room.

Week 4

Mother removed for short periods of up to 1 hour to encourage sibling play and discourage separation anxiety.

Puppies fed twice daily a mix of 90% skimmers puppy milk, 10% kibble. Kibble to be soaked in the hot milk mixture, and allowed to cool to a suitable temperature for feeding.

Suitable movement and activity to be monitored. Any puppies not demonstrating suitable movement to be closer monitored. Should their condition deteriorate they are to be presented to the vet.

Weighed daily to monitor growth.

Additional human interaction given, play time with both adults and children.

Wormed with Panacur 3 day wormer.

Flea treated with FiprocLEAR spray.

Week 5

Mother removed for periods of up to 2 hours to encourage sibling play and discourage separation anxiety.

Puppies fed twice daily a mix of 75% skimmers puppy milk, 25% kibble. Kibble to be soaked in the hot milk mixture, and allowed to cool to a suitable temperature for feeding.

Suitable movement and activity to be monitored. Any puppies not demonstrating suitable movement to be closer monitored. Should their condition deteriorate they are to be presented to the vet.

Weighed daily to monitor growth.

Additional human interaction given, play time with both adults and children.

All puppies to be microchipped.

Week 6

Mother removed for periods of up to 4 hours to encourage sibling play and discourage separation anxiety.

Puppies fed 3 times daily a mix of 50% skimmers puppy milk, 50% kibble. Kibble to be soaked in the hot milk mixture, and allowed to cool to a suitable temperature for feeding.

Suitable movement and activity to be monitored. Any puppies not demonstrating suitable movement to be closer monitored. Should their condition deteriorate they are to be presented to the vet.

Weighed daily to monitor growth.

Additional human interaction given, play time with both adults and children.

Wormed with Panacur 3 day wormer.

Flea treated with FiprocLEAR spray.

Week 7

Mother removed during the day to encourage sibling play and discourage separation anxiety.

Puppies fed 4 times daily a mix of 25% skimmers puppy milk, 75% kibble. Kibble to be soaked in the hot milk mixture, and allowed to cool to a suitable temperature for feeding.

Suitable movement and activity to be monitored. Any puppies not demonstrating suitable movement to be closer monitored. Should their condition deteriorate they are to be presented to the vet.

Weighed daily to monitor growth.

Additional human interaction given, play time with both adults and children.

Interaction with other dogs within the house to be introduced.

Week 8

Mother removed during the day to encourage sibling play and discourage separation anxiety.

Puppies fed 4 times daily dry kibble. A small splash of milk may be used to encourage feeding.

Suitable movement and activity to be monitored. Any puppies not demonstrating suitable movement to be closer monitored. Should their condition deteriorate they are to be presented to the vet.

Weighed daily to monitor growth.

Additional human interaction given, play time with both adults and children.

Interaction with other dogs within the house to be continued.

Wormed with Panacur 3 day wormer.

Flea treated with FiprocLEAR spray.

Puppies to be presented vet for thorough health check and first vaccine.

Week 9 - 10

Puppies may leave to new homes.

Remaining puppies to have mother removed.

Puppies fed 4 times daily dry kibble. A small splash of milk may be used to encourage feeding.

Suitable movement and activity to be monitored. Any puppies not demonstrating suitable movement to be closer monitored. Should their condition deteriorate they are to be presented to the vet.

Additional human interaction given, play time with both adults and children.

Interaction with other dogs within the house to be introduced.

Second vaccine to be administered at 10 weeks of age.

Adult dogs

Animal first aid kit to be maintained and available for use.

Teeth, pads, nails, eyes, joints inspected weekly.

Flea and worm treated monthly 10 weeks to 12 months. Adults 3 monthly.

Booster vaccine & veterinary health check yearly.

All females to be given herpes vaccine at mating and 3 days before whelping.

All bitches to be 12 months old prior to mating.

Stud dog and bitch must have a COI of less than the breed average.

Bitches must not whelp more than 1 litter in a 18 month period, or 4 litters in their life time.

Bitches must not have more than 1 caesarean section in their lifetime.

Indoor adults are to allowed outside to exercise and mess a minimum of 3 hourly 7am-10pm

Infection control

Should any dog present signs of an illness it is to be presented to a vet at the next available appointment. The vet will advise on the appropriate course of action.

This may include, hospitalisation, medication and to live at home, live at home in isolation.

Should home isolation be required, the dog is to be placed into isolation in the approved location away from other dogs.

Isolated dogs must be checked 2 hourly, regularly exercised, and taken to the toilet.

Hands and footwear must be sanitised before and after contact with any isolated dog.

Veterinary contacts:

Fiona Forrest
Vet4Pets Kendal
01539 742910

Oakhill Vets
Langley Lane, Goosnargh, 01772 861300

Out of hours Veterinary contacts:

Greenways Vets
4 Greenways, Lytham
01253 729309

Vets Now
90 Noor Lane, Preston
01772 301382

Cleaning and hygiene

Water bowls to be cleaned and refilled daily

Food bowls to be cleaned after each use.

Only G9 or Virkon S disinfectants to be used in dog areas.

Puppy mess to be collected twice daily. Bedding removed, area disinfected and bedding replaced daily.

Adult dog mess to be collect 3 times daily. Area to be washed down daily. Deep clean, jet wash and disinfection minimum 3 times weekly.

Food

Food served is to be suitable to the individual's needs. Generally adult dogs are fed Autarky Adult, and puppies fed Autarky Puppy.

Dry kibble is to be stored sealed in bags, and transferred to dedicated feed bins, kept indoors.

Puppy milks to be used are Royal Canin ProTech, Skinners puppy milk, or Provimi multimilk.

Emergency Contacts

In the case of an emergency, the following are to be contacted.

Mandy Wood

Jayne Ford

Should any dogs need to be evacuated from the property in an emergency situation, an agreement has been reached for them to be transported to and cared for by

Longview Boarding Kennels
Division lane
Blackpool

Visitors

To be fully covered with a risk assessment.

All visitors are to be requested to wear clean clothes, foot dip upon entering the property, and hand sanitise before handling puppies.

Puppies mother is to be present whilst visitors are present, however is to be removed prior to any visitor handling puppies as to avoid distressing the mother.

First aid kit to be maintained and available for use.

Fire

To be fully covered with a risk assessment.

Fire extinguisher and fire blanket to be in a prominent location and ready for use.

First aid kit to be maintained and available for use.

Typical Daily Routine

7:00	All dog mess cleaned up, puppies & adults. Water bowls cleaned and refilled. Indoor adults taken outside to toilet.
7:30	All dogs fed.
8:00	Food bowls collected and cleaned.
9.30	Puppies inspected and weighed. Indoor adults taken outside to toilet.
10:00	Adult dogs walked to van 1 at a time and inspected for any lameness or ill health. Dogs to be loaded into secure travel compartment within van.
11:00	Adult dogs walked on private field, minimum 30 minutes.
12:00	Puppies fed. Adult dog mess removed and washed down. Dogs replaced back into living accommodation. Indoor adults taken outside to toilet.
14:00	Indoor adults taken outside to toilet Puppies fully cleaned out, bedding removed, fresh put down.
16:00	Puppies fed. Indoor adults taken outside to toilet.
18:00	Indoor adults taken outside to toilet. Additional walk for larger dogs. On lead from the house. Dog mess picked up.
19:00	Puppies inspected and weighed. Weights recorded and wormer/flea treatment applied if required.
20:00	Puppies fed. Indoor adults taken outside to toilet.
22:00	Indoor adults taken outside to toilet.

Risk Assessment - Record of significant findings		
<i>Risk assessment for</i> 8 St Martin Road Blackpool FY4 2DY		<i>Assessment undertaken by</i> Date: 18/12/2018 Completed by: Lloyd Wood Signature: L Wood
Sheet number Floor/area: Two storey semi-detached house, with three bedrooms, bathroom, utility room, kennels & kitchen		Use: Residential property occupied by five Individuals, & 9 dogs.
Step 1 - Identify fire hazards		
<i>Sources of ignition</i> Boiler Log burner Heat lamps Cooking Electrical Installation Gas Installation Candles	<i>Sources of fuel</i> Furniture Towels Blankets Soft furnishings Dog bedding	<i>Sources of oxygen</i> None other than naturally occurring
Step 2 - People at risk		
Residents and visitors to the property		
Step 3 - Evaluate, remove, reduce and protect from risk		
What are the risks? Who is at risk? Action taken to remove and reduce the hazards that may cause a fire Action taken to remove and reduce the risk to people from a fire	Risk from cooking, heat lamps, boiler, candle burning, log burner, electricals. Fire can spread throughout the property and kennels. House members and visitors at risk. Candles banned during the night within the property. Log burner to be out during the night. Heat lamps to be installed at manufacturers recommended distance from combustibles. Electrical Installation tested for safety. Gas Installation tested for safety. Fire loading to be kept to a minimum. All plugs and cables to be routinely examined for splits or deformities. Fire extinguisher and blanket installed. House members instructed how to safely use fire blanket and extinguisher. Fire alarms installed and routinely inspected. Access and egress routes to be reasonably clear. House members to be familiar with exit routes. Only one visiting family at a time.	
Assessment review Assessment/ review date 18/12/2019	Completed by	Signature

What are the hazards?	Who might be harmed and how?	What are you already doing?	What further action is necessary?	Action by whom?	Action by when?	Done?
Dog bite	House members and visitors may be bitten by an adult or puppy.	House members competent and confident in handling dogs. First aid kit available and maintained. No unsupervised children to be with dogs.	Remind house members and visitors of hazard.	K. Stock	31/12/18	18/12/18
Slips, trips & falls	House members and visitors risk injury if they slip or trip.	Suitable lighting installed. Suitable footwear to be worn. Access and egress to be clear. Trailing leads to be kept to a minimum.	House members to clear as they go.	K. Stock	31/12/18	18/12/18
Electricity	House members risk serious, possibly fatal injuries from a faulty electrical installation or appliances.	Electrical installation installed by a competent person and protected from water ingress where necessary. All circuits are RCD protected. Leads and plugs regularly inspected by L Wood	No further action required.			
Disease	Animals, house members and visitors risk contracting disease from dog mess.	Cleaning plan in place and to be adhered to.	No further action required.			
Manual handling	House members risk injury from handling sacks of food.	Only 1 bag to be carried at a time.	House members reminded on correct manual handling techniques.	K. Stock	31/12/18	18/12/18
Driving	K Stock, L Wood risk car accidents whilst driving to suitable dog walking area.	Driving laws (speed limits, drink driving ect) to be adhered to.	No further action required.			
Lone working	K Stock, L Wood at risk whilst lone working.	Phones to be charged and carried whilst lone working incase of accident.	No further action required.			

Section 13

Premises plan

Inside:

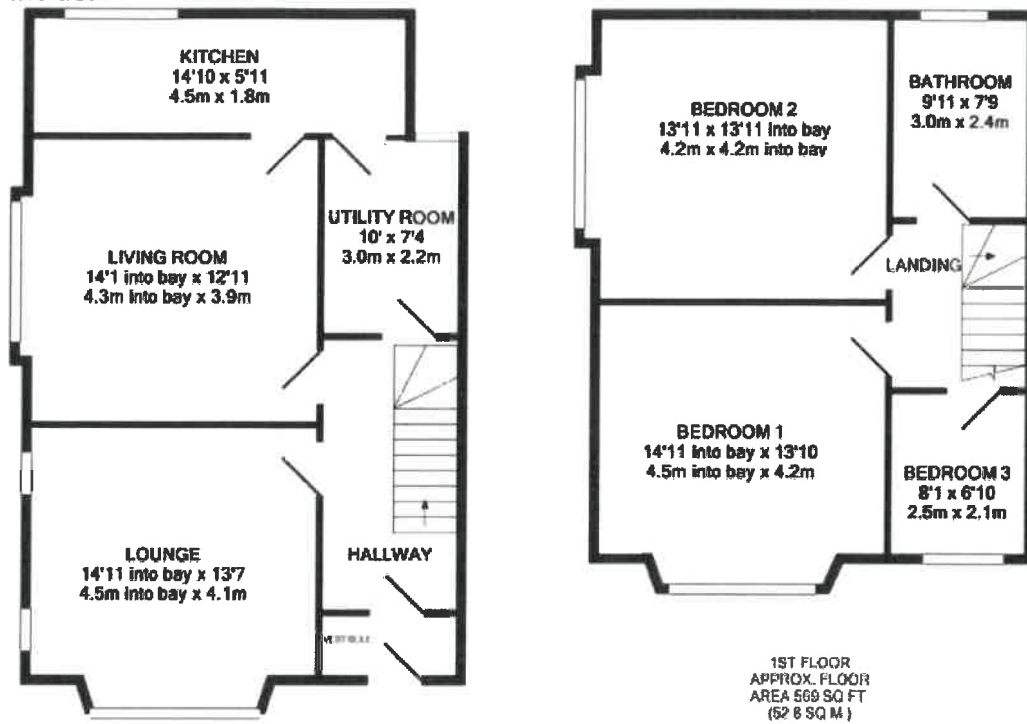

Living room and utility room areas to be used for dogs / puppies.

Outside:

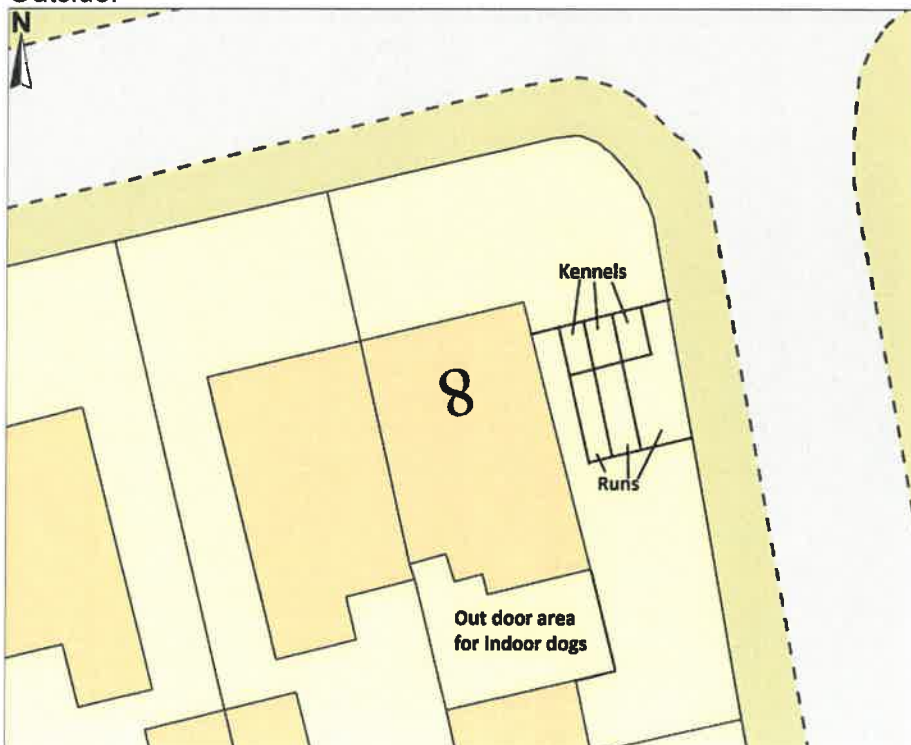

Puppy Sales Contract

Owner Name	Breeder:	Kathryn Stock
Address		8 St Martins Road
		Blackpool
		FY4 2DY
Email Address		
Telephone number		

Puppy Name	Date of Birth	Breed
Colour	Sex F/M	Price £
Dam name	Colour	Date of Birth
Microchip No		
Sire name	Colour	Date of Birth
Microchip No		

TERMS AND CONDITION OF SALE: This puppy is being sold as a pet only. A health check carried out on _____ found this puppy to be in good health.

NOTES _____

If you are collecting the puppy prior to a vet check, please do so with the first three days of collection.

Remember just like children it is possible that as your puppy grows it could become ill at some time. In the majority of cases this will be nothing more than a short-term minor upset that may require medical attention (please notify myself in the first instance). We strongly advise to use a reputable insurance tailored for pets, for the lifetime of the puppy. Cheaper insurances may not cover any long-term illness that may occur in later life.

We wish you many long and happy years with your puppy, we do understand that things do not always work out as planned. Should you decide your new puppy isn't working for you within the first three days of purchase, we will happily take the puppy back for re homing and a non-negotiable refund of 50% of the purchase price paid on the date of collection will be returned to you on the puppy's safe return in the condition he/she was collected.

However, if the puppy is deemed to have a life-threatening illness, that is confirmed in writing from your veterinarian within the first seven days, upon the return of the puppy to ourselves a full refund will be given. Please note all vet's fees must be covered by you as the new owner or your insurers. If the puppy is not taken to your allocated veterinarian within three days, then it is taken that you have accepted the puppy's health to be satisfactory to yourself.

Please sign below to acknowledge that you have read and accepted the terms and condition above, so that we are confident of your puppy's long-term health and happiness.

Thank you and please do feel free to ring for any advice regarding your new family member, we are always happy to help with the transition from our home to yours.

BREEDERS SIGNATURE:

DATE:

NEW OWNERS SIGNATURE:

DATE:

